

EXIT 55 - CTY C, CAMP DOUGLAS, VOLK FIELD

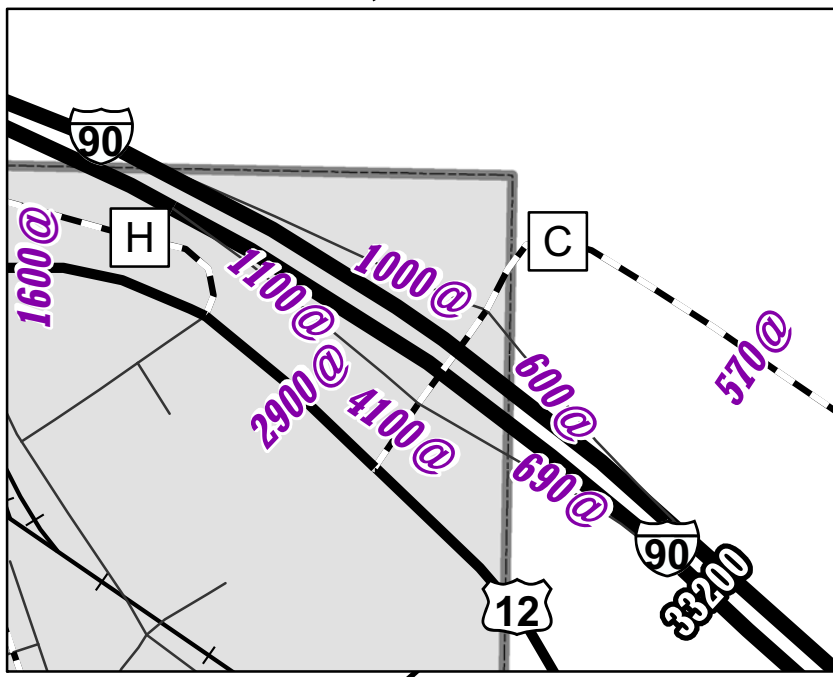

EXIT 61 - HWY 80, NECEDAH, NEW LISBON

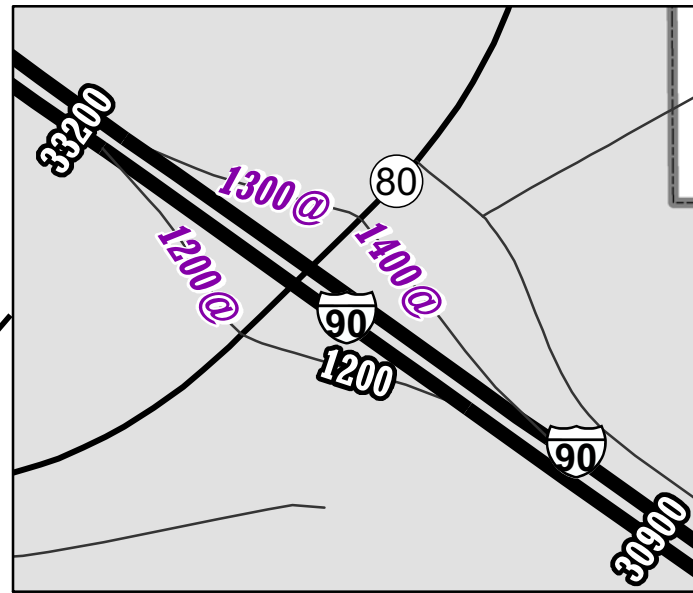

EXIT 79 - CTY HH, LYNDON STATION

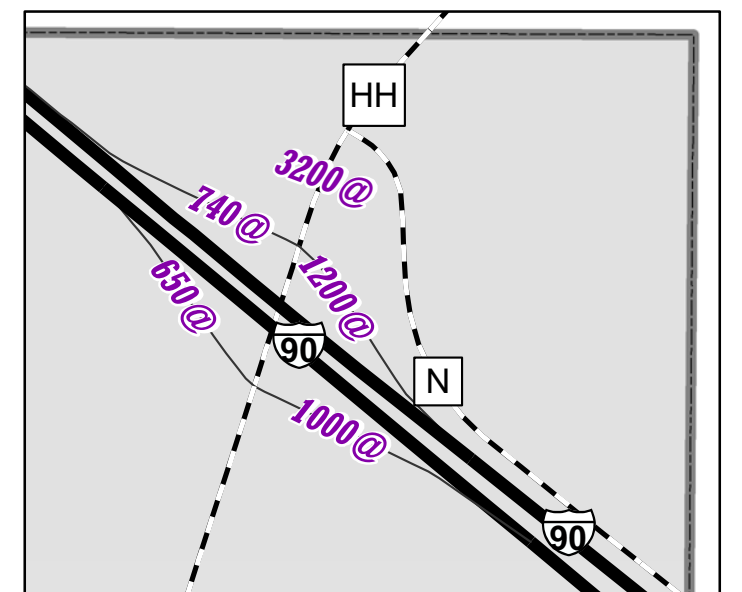

EXIT 69 - HWY 82, MAUSTON, NECEDAH

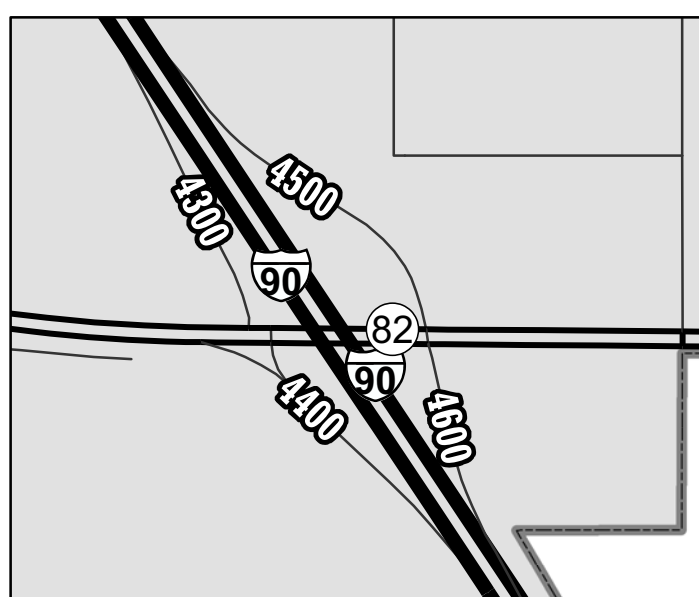

EXIT 85 - HWY 12, 16, WIS DELLS

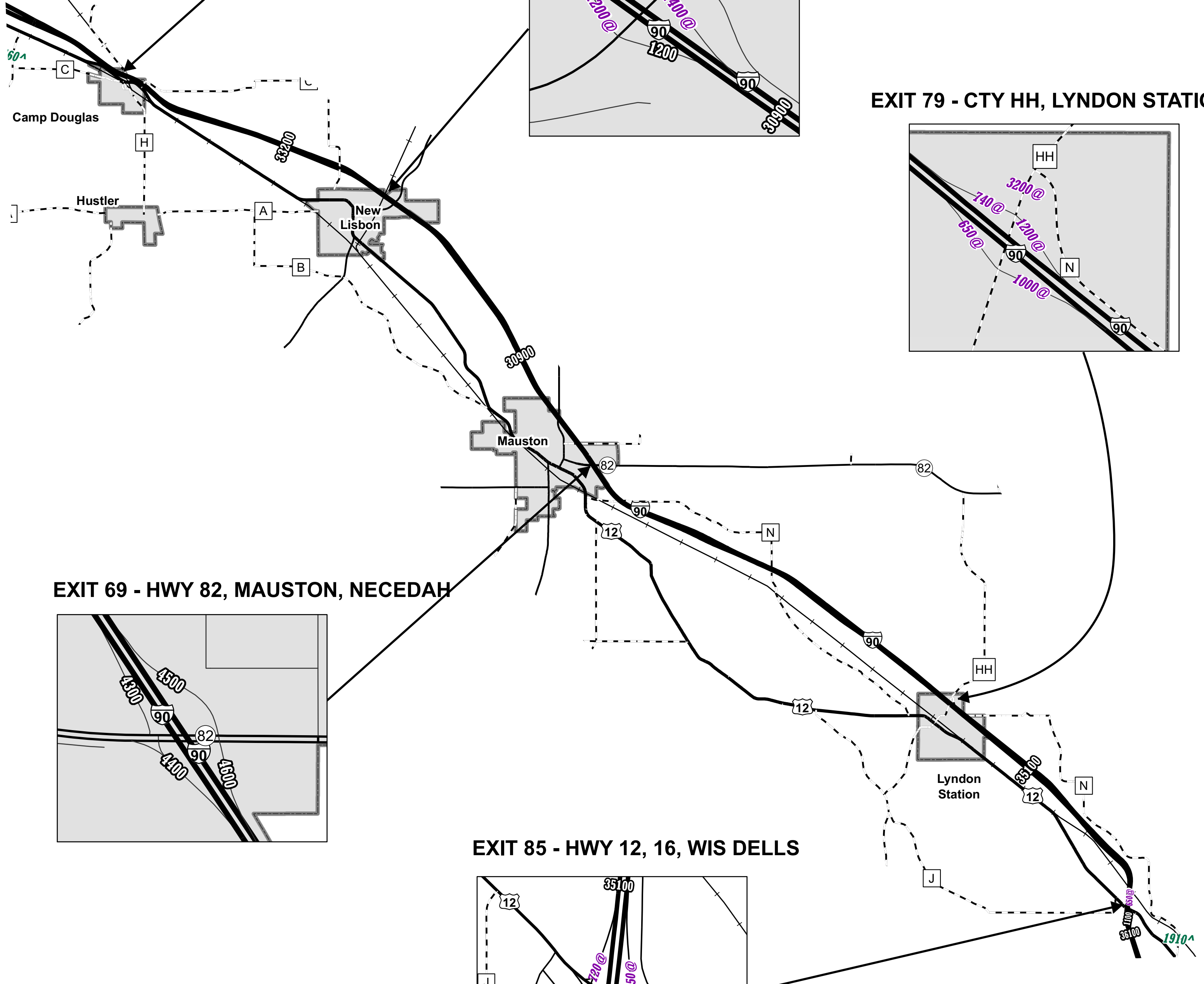
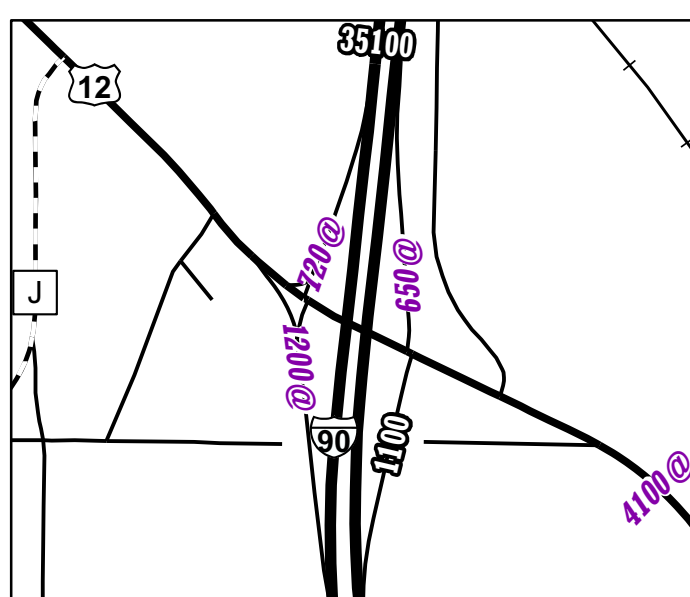

2007
INTERSTATE SYSTEM
JUNEAU County
 Annual Average Daily Traffic

9999 - AADT - 2007
 9999# - AADT - 2006 9999^ - AADT - 2003
 9999* - AADT - 2005 9999~ - AADT - 2002
 9999@ - AADT - 2004 9999x - AADT - 2001 or older
 - Character following AADT on map designates year
 - AADT for RAMPS lie parallel to road
 - AADT for Roads lie perpendicular to road

Legend
 — IH
 — USH
 — STH
 - - - CTH
 — Local Roads
 — Railroads